



# 61809-2RZ Deep groove ball bearings

- Popular item

## Deep groove ball bearings

### Bearing data

[Tolerances](#),

Normal (metric), P6, P5, Normal (inch),

[Radial internal clearance](#),

Matched bearing pairs, Stainless steel  
d < 10 mm, Other bearings

### Bearing interfaces

[Seat tolerances for standard conditions](#),

[Tolerances and resultant fits](#)

## Technical specification

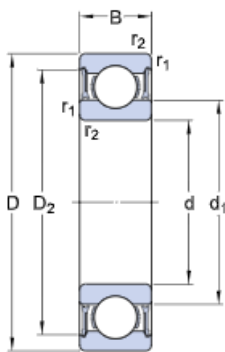

### DIMENSIONS

d	45 mm	Bore diameter
D	58 mm	Outside diameter
B	7 mm	Width
d <sub>1</sub>	≈ 48.2 mm	Shoulder diameter
D <sub>2</sub>	≈ 55.4 mm	Recess diameter
r <sub>1,2</sub>	min. 0.3 mm	Chamfer dimension

### ABUTMENT DIMENSIONS

d <sub>ε</sub> min.	47 mm	Diameter of shaft abutment
d <sub>ε</sub> max.	49 mm	Diameter of shaft abutment
D <sub>i</sub> max.	56 mm	Diameter of housing abutment
r <sub>a</sub> max.	0.3 mm	Radius of shaft or housing fillet

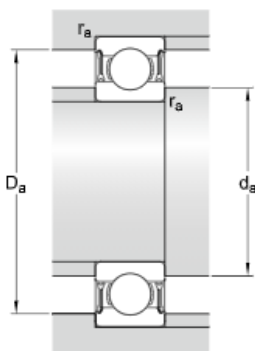

## CALCULATION DATA

C	5.72 kN	Basic dynamic load rating
C <sub>0</sub>	5 kN	Basic static load rating
P <sub>u</sub>	0.212 kN	Fatigue load limit
	24 000 r/min	Reference speed
	12 000 r/min	Limiting speed
k <sub>r</sub>	0.015	Minimum load factor
f <sub>0</sub>	15.1	Calculation factor

## MASS

	0.04 kg	Mass bearing
--	---------	--------------

## TOLERANCE CLASS

Normal	Dimensional tolerances
Normal	Radial run-out